



IRIS

REPLACING THE LEGS

To replace a leg, remove the set screw in the bottom of the leg using the small 1.5 mm Allen key.



Slide out the leg to remove it, and replace with the new leg. Replace the set screw until it secures the leg, but not so that it is screwed completely into the arm where it could interfere with the motor.

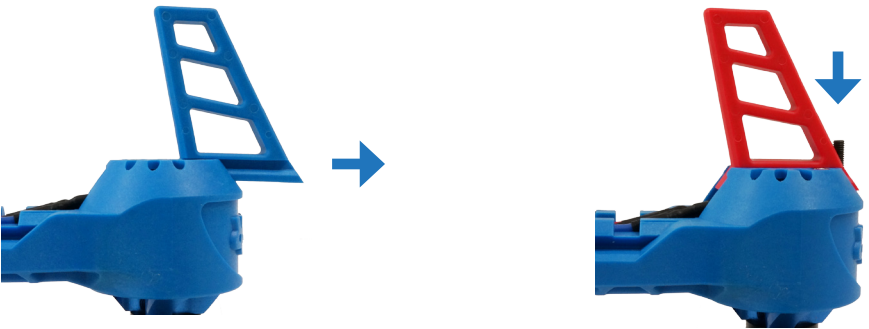

ONLINE RESOURCES

Visit copter.ardupilot.com for more information, instructions, safety information, tutorials, and more.

SUPPORT

Need help? Contact us at help@3drobotics.com or call our support line at +1 (858) 225-1414.

PURCHASE

Get Iris accessories, APM:Copter add-ons, apparel, and more at store.3drobotics.com.



3DROBOTICS.COM